

# Vacuum Relays

# V47A V47B

Reference Model, Kilovac/Jennings: K47A/RF6A, RF6C, RF6D; K47B/RF5A, RF5C, RF5D.

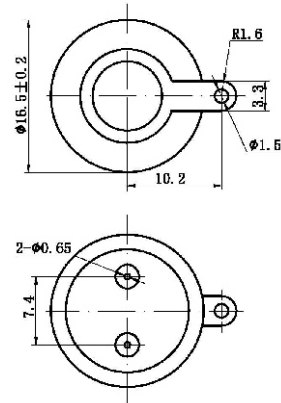
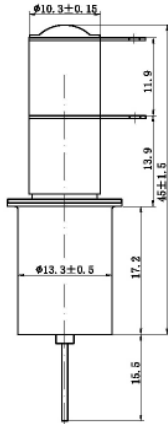

SPECIFICATIONS				
Contact & Ratings	Units	V47A	V47B	
Contact Form		A	B	
Contact Arrangement		SPST-NO	SPST-NC	
Test Voltage, (DC or 60Hz)	KV, Peak	9	9	
Operating Voltage	DC or 60Hz	KV Peak	8	8
	2.5MHz	KV Peak	7.5	7.5
	16MHz	KV Peak	7	7
	32MHz	KV Peak	5	5
Current, Continuous Carry, Max.	dc or 60Hz	Amps	12	12
	2.5MHz	Amps	10	10
	16MHz	Amps	5	5
	32MHz	Amps	3	3
Coil Hi-Pot (V RMS, 60Hz)	V	500	500	
Capacitance	Across Open Contacts	pF	1.2	1.2
	Contacts to Ground	pF	1.2	1.2
Resistance, Contact Max. @1A, 28Vdc	ohms	0.03	0.03	
Operate Time	ms	10	10	
Release Time	ms	10	10	
Life, Mechanical	Cycles	2 million	2 million	
Vibration, Operation, Sine (55~2000 Hz Peak)	G's	10	10	
Shock, Operating, 1/2 Sine 11ms(Peak)	G's	30	30	
Temperature Ambient Operating	°C	-55 to +125	-55 to +125	
Weight, Nominal	g (oz)	25 (0.9)	25 (0.9)	

COIL RATINGS		
Nominal, Vdc, Max.	12	26.5
Pick-up, Vdc, Max.	8	16
Drop-out, Vdc	0.5-5	1-10
Coil Resistance (Ohms, ±10%)	230	920

\*Ratings listed are for 25°C, sea level conditions.

